

The following addendum is intended to assist users installing StrongArmDOT 28 operator. StrongArmDOT operator differs from standard StrongArm models by inclusion of a breakaway arm bracket, adjustable arm height, and quantity of counterweights used. Please read all assembly instructions before installing kit.

Quality is a top priority at HySecurity.

NOTICE

Maintain tagged service nut on breakaway king pin during installation. Remove service nut after installation is complete and breakaway bracket is fully secure.

1. If necessary, reposition operator side arm mounts on arm height adjustment legs to adjust operator arm height. See **Figure 1, A**.
2. See Table 1 for operator arm length and counterweight options for ideal operator performance.
3. Using a socket and ratchet, secure conversion bracket to two Gate Saver Yokes using four bolts, eight flat washers, four lock washers, and four nuts. See **Figure 1, B**.
4. Using an open-ended wrench, remove the bolt, lock washer, and flat washer from the breakaway king pin head attached to the cast adapter. See **Figure 1, C**.
5. Rotate breakaway king pin so alignment pin aligns with cast adapter shear brass bolt mounting locations (3). See **Figure 1, C**.
6. Align cast adapter and breakaway king pin with the forward panel of the conversion bracket. Use an open-ended wrench to resecure bolt, lock washer, and flat washer to breakaway king pin head. See **Figure 1, C**.
7. Using a socket and ratchet, secure three brass shear bolts, lock washers, and hex nuts to the cast adapter and conversion bracket. See **Figure 1, D**.

NOTICE

For initial installation, install two brass shear bolts and hardware. Number of brass shear bolts used is dependent upon arm length and anticipated wind load. Shorter arms may require one brass shear bolt. Longer arms in windy areas may require three brass shear bolts.

8. Using a socket and ratchet, secure the gate saver sleeve arm to cast adapter, and gate saver barrier arm to gate saver sleeve arm using six bolts, flat washers, and nylon locknuts. See **Figure 1, E**.

Table 1. Arm Length and Counterweights

Arm Length (feet)	Standard StrongArm		StrongArmDOT	
	No. of Counterweights per side	Stud Length (inches)	No. of Counterweights per side	Stud Length (inches)
12	0	2.5"	1	2.5"
14	0	2.5"	1	2.5"
16	0	2.5"	1	2.5"
18	0	2.5"	1	2.5"
20	1	2.5"	2	2.5"
22	2	2.5"	3	2.5"
24	3	3.5"	4	3.5"
26	5	3.5"	6	5.0"
28	6	5.0"	7	6.0"
30	8	6.0"	-	-
32	9	7.5"	-	-
34	11	7.5"	-	-
36	12	7.5"	-	-

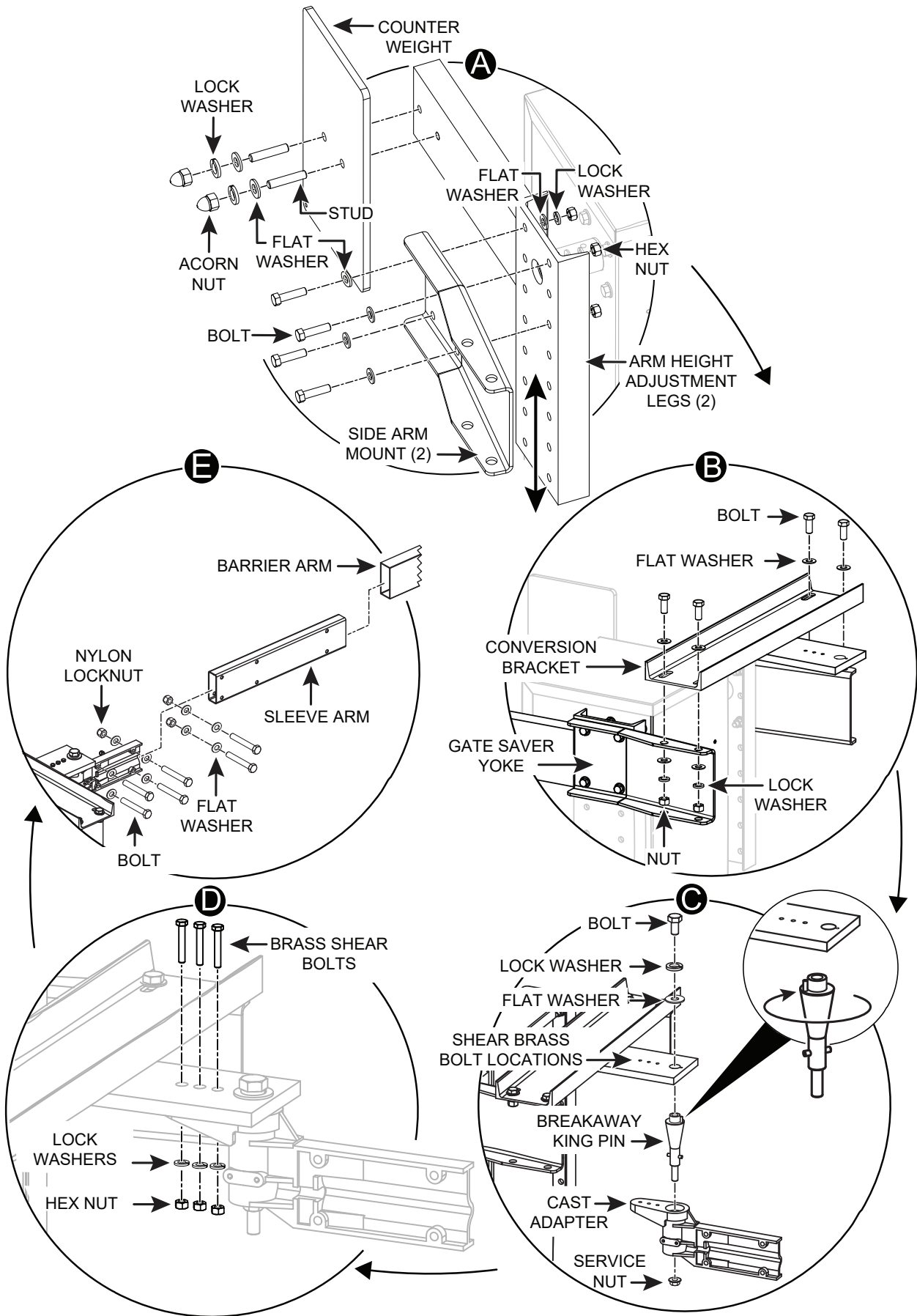

Figure 1. StrongArmDOT 28 Breakaway Arm Installation Instructions