

The following instructions are intended to assist the user in the installation of the SlideSmartDC HD Heater Kit. Please read all assembly instructions before installing the kit.

REQUIRED TOOLS

- Screwdriver

PARTS

Verify that all parts included in heater kit are accounted for. See Figure 1 and Table 1.

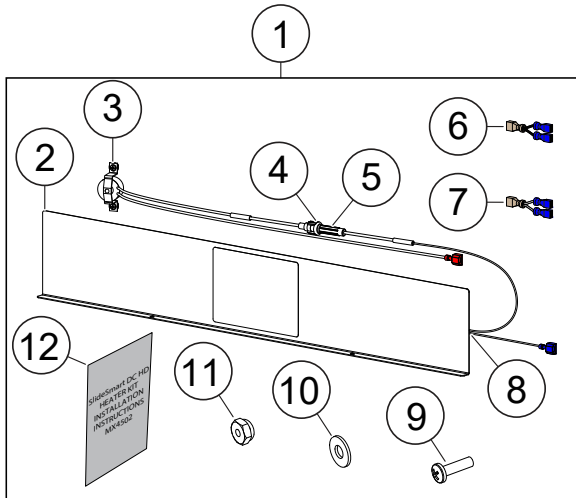

Figure 1. SlideSmartDC HD Heater Kit Parts

Table 1. SlideSmartDC HD Heater Kit

Item No.	Part No.	Description	QTY.	Remarks
1	MX4397	Heater Kit, SSHD, 115V	1	Includes items 2-12
1	MX4423	Heater Kit, SSHD, 230V	1	Includes items 2-12
2	MX4398	Bracket, Heater, SSHD	1	
3	MX001875	Heater Thermostat, ON 40 OFF 60	1	
4	MX4413	Holder, Fuse, 1/4 x 1-1/4, Inline	1	
5	MX4424	Fuse Glass, 3A 250VAC 3AG	1	
6	MX2879-01	Heater, Adaptor, Black	1	
7	MX2879-02	Heater, Adaptor, White	1	
8	MX3311-01	Heater Strip, 24", 115V	1	
8	MX3311-02	Heater Strip, 24", 230V	1	
9	MX001342	#6-32 x 1/2, Screw	2	
10	MX001343	Flat Washer, #8	2	
11	MX000949	Nut, Lock, #6-32	2	
12	MX4502	Instructions, SlideSmart DC HD Heater Kit Installation		

WORK SAFELY!

Only a **qualified service technician** with proper training should perform this installation. Follow all safety rules when performing this installation.

PREPARATION

1. Verify heater kit and operator voltage are the same.
2. Make sure gate operator is turned off and moving components are idle.
3. Turn off the breaker.
4. Unlock and remove cover using key.
5. Set the cover, control box cover, and high voltage cover aside.

THERMOSTAT INSTALLATION

1. Route heater kit white and black wires through two bottom high voltage box split bushings. Connect heater kits wires to same colored crimped wires provided. See **Figure 2, A**.
2. Disconnect and replace original top AC power switch white and black wires with heater white and black wires respectively. See **Figure 2, B**.
3. Connect original AC power switch white and black wires to the same colored heater wire leads. See **Figure 2, C**.
4. Remove the inner forward screw from the left and right conduit covers. See **Figure 2, D**.
5. Align heater bracket mounting holes with left and right conduit cover inner forward screw locations. Secure heater bracket with screws removed in Step 4. See **Figure 2, D**.
6. Position and align thermostat 2-1/4 inches above inner bottom PEM nut, and 1-3/4 inches from the front edge on AC-DC power switch side of voltage box using 6-32 screws (2), flat washers (2), and lock nuts (2). See **Figure 2, E**.

NOTICE

Thermostat mounting locations may not be pre-drilled depending on your operator manufacture date. Self drill mounting locations using the provided dimensions in **Figure 2, E**. Ensure high voltage cover is installed when drilling and clean out all shavings.

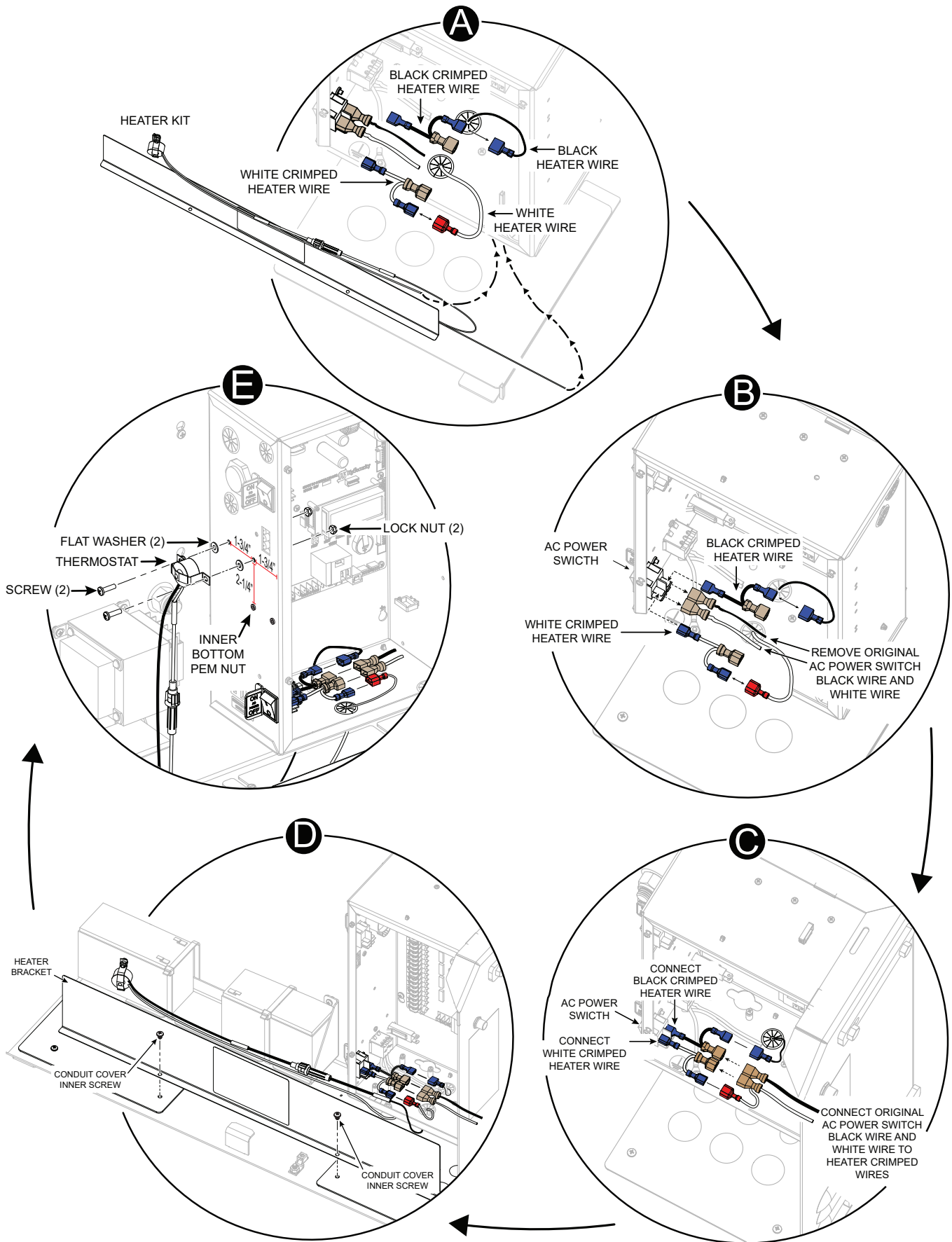

Figure 2. Heater Kit Thermostat Installation