

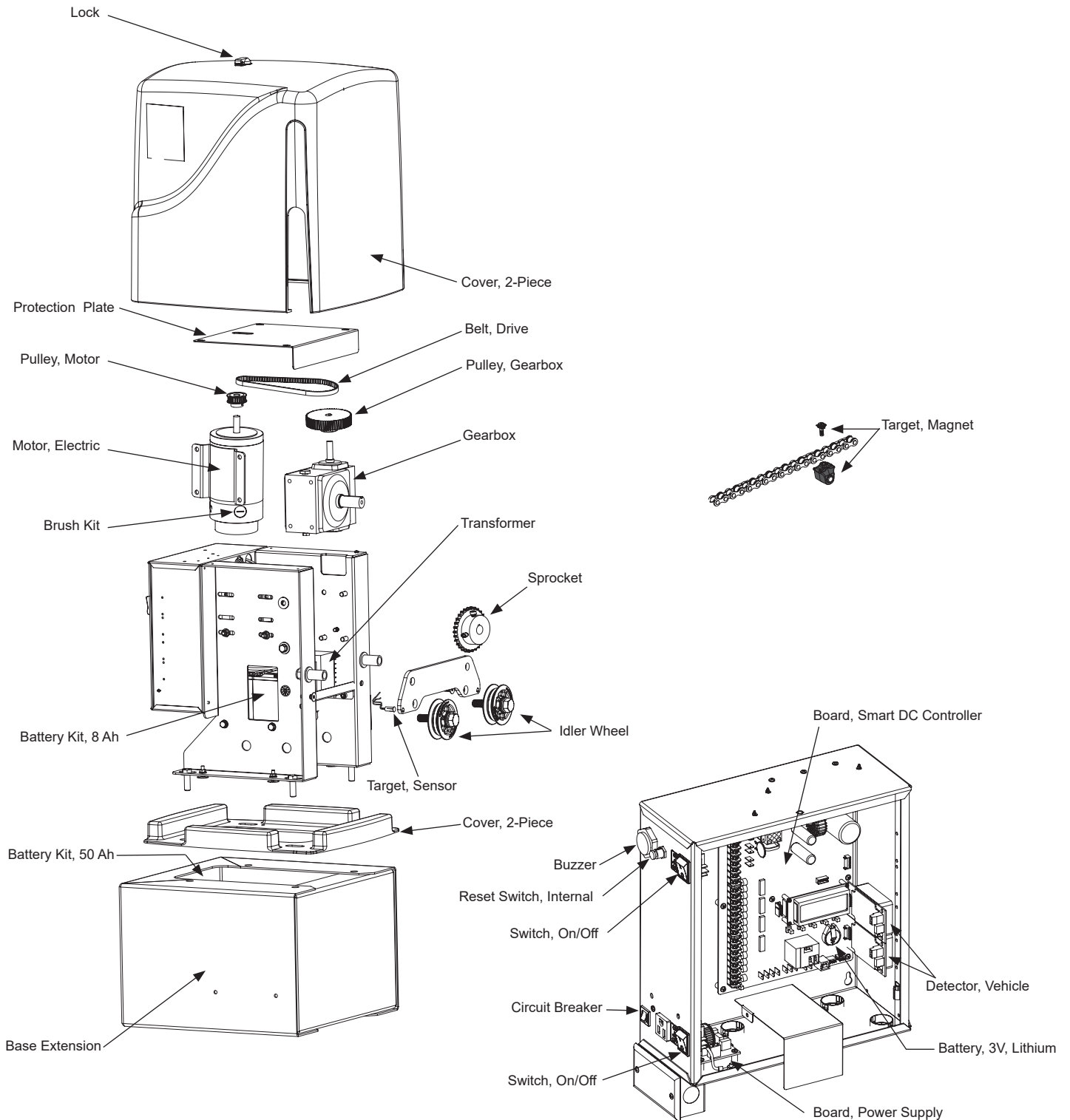

SlideSmart™ DC

Part Diagrams

10F, 15 Chassis, Mechanical & Electrical



This drawing is a representation and should be used for parts reference only.

SlideSmart™ DC

Part Diagrams



10F, 15 Chassis, Mechanical & Electrical

| Part Name | Part Number | SlideSmart DC Models |
|--|-------------|------------------------------|
| Base Extension, SlideSmart DC 10F, 15 | MX002094 | SlideSmart DC 10F, 15 |
| Battery Kit, 50Ah, Replacement | MX002013 | all |
| Battery Kit, 8Ah, Replacement | MX002008 | all |
| Battery, 3V, Lithium | MX000346 | all |
| Belt, Drive, SlideSmart DC 10F | MX002107 | SlideSmart DC 10F |
| Belt, Drive, SlideSmart DC 15, HD25/30 | MX002106 | SlideSmart DC 15 |
| Board, Power Supply, 115/230VAC | MX001766 | AC only |
| Board, Smart DC Controller | MX3037-0 | all |
| Brush Kit, 24VDC Motor, Smart DC | MX001920 | all |
| Buzzer, Piezo | MX001036 | all |
| Circuit Breaker, 15A | MX001760 | Solar only |
| Circuit Breaker, 5A | MX3796 | AC only |
| Cover, 2-Piece | MX002115 | all |
| Cover, Top Plate | MX002075 | all |
| Detector, Vehicle, Hy5B™ | MX4621 | all |
| Gearbox, SlideSmart DC | MX002210 | all |
| Idler Wheel, #40 Roller Chain Guide | MX002181 | all |
| Lock, Latch, w/Key | MX002873 | all |
| Motor, Electric, 24VDC | MX001995 | all |
| Pulley, Gearbox, 36T, 15mm | MX001404 | all SlideSmart DC 10F models |
| Pulley, Gearbox, 60T, 15mm | MX002076 | all SlideSmart DC 15 models |
| Pulley, Motor, 24T, 9 mm | MX001403 | all |
| Reset Switch, Internal | MX002124 | all |
| Sprocket, #40 Roller Chain, 30T | MX002211 | all |
| Switch, On/Off | MX001761 | all |
| Target, Magnet, Assembly | MX002087 | all |
| Target, Sensor | MX002085 | all |
| Transformer, 115/208/230VAC | MX002798 | AC only |